

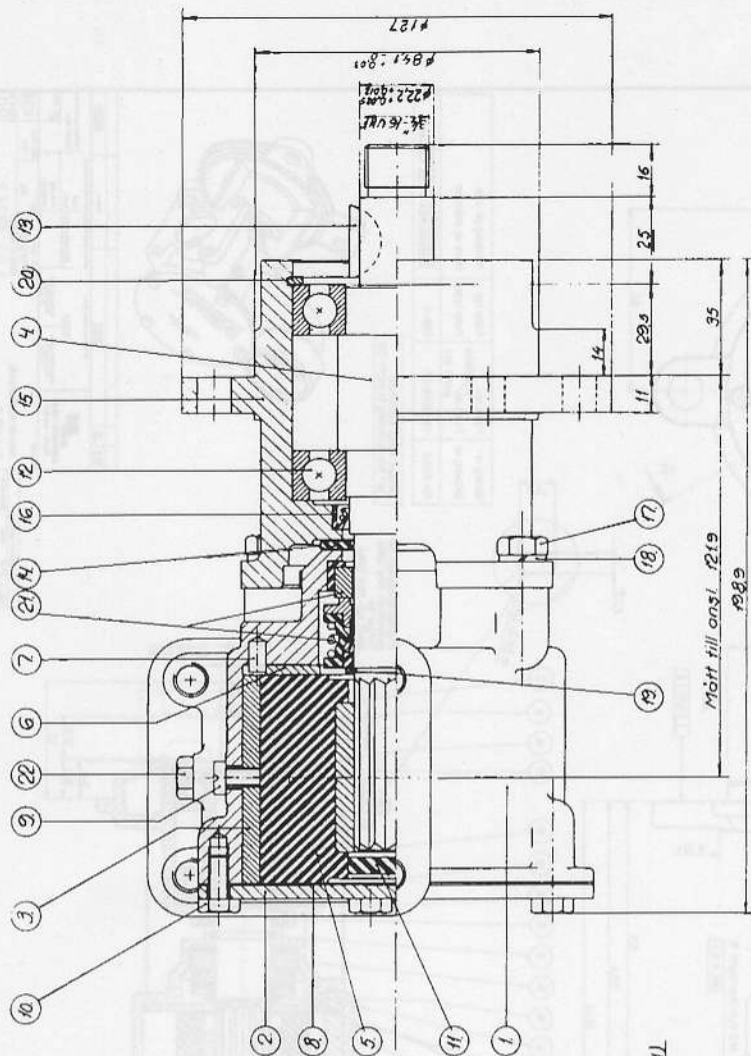

Pump No. 10-21915-2	Pump type F8B-903	Endcover Lock	Mark on endcover Märkes på lock
			01-72172-1 F8B-903 10-21915-2 + monthly code

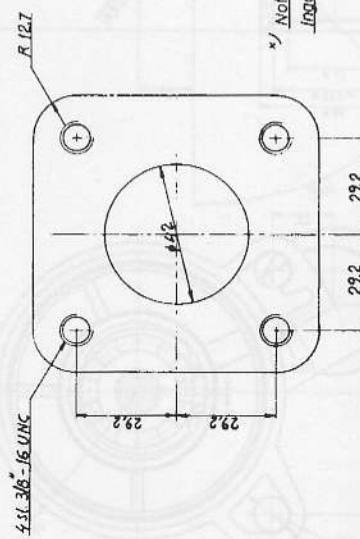
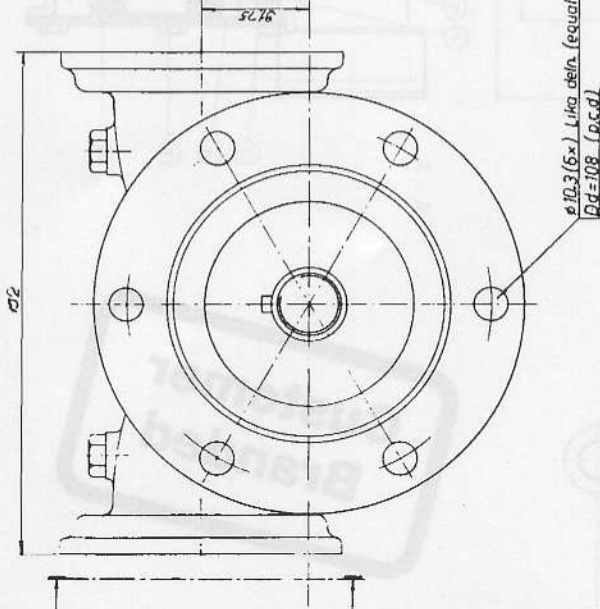

Part No.	Part Name	Material	Quantity	Notes
1	Plug	Steel	1	
2	Mech. seal	Steel	1	
3	Retaining ring	Steel	1	
4	Retaining ring	Steel	1	
5	Washer	Steel	1	
6	Ball	Steel	1	
7	Lip seal	Steel	1	
8	Bearing house	Steel	1	
9	Slinger	Steel	1	
10	Woodruff key	Steel	1	
11	Ball bearing	Steel	1	
12	Washer	Steel	1	
13	Ball	Steel	1	
14	Screw	Steel	1	
15	Washer	Steel	1	
16	Pin	Steel	1	
17	Impeller	Steel	1	
18	Shaft	Steel	1	
19	Endcover	Steel	1	
20	Body	Steel	1	
21	Mech. seal	Steel	1	
22	Retaining ring	Steel	1	

37	05-04-46 var 05-04-146	1712.80	✓
38	05-04-46 var 05-04-146	1712.80	✓
39	05-04-46 var 05-04-146	1712.80	✓
40	05-04-46 var 05-04-146	1712.80	✓
41	05-04-46 var 05-04-146	1712.80	✓
42	05-04-46 var 05-04-146	1712.80	✓
43	05-04-46 var 05-04-146	1712.80	✓
44	05-04-46 var 05-04-146	1712.80	✓
45	05-04-46 var 05-04-146	1712.80	✓
46	05-04-46 var 05-04-146	1712.80	✓
47	05-04-46 var 05-04-146	1712.80	✓
48	05-04-46 var 05-04-146	1712.80	✓
49	05-04-46 var 05-04-146	1712.80	✓
50	05-04-46 var 05-04-146	1712.80	✓
51	05-04-46 var 05-04-146	1712.80	✓
52	05-04-46 var 05-04-146	1712.80	✓
53	05-04-46 var 05-04-146	1712.80	✓
54	05-04-46 var 05-04-146	1712.80	✓
55	05-04-46 var 05-04-146	1712.80	✓
56	05-04-46 var 05-04-146	1712.80	✓
57	05-04-46 var 05-04-146	1712.80	✓
58	05-04-46 var 05-04-146	1712.80	✓
59	05-04-46 var 05-04-146	1712.80	✓
60	05-04-46 var 05-04-146	1712.80	✓
61	05-04-46 var 05-04-146	1712.80	✓
62	05-04-46 var 05-04-146	1712.80	✓
63	05-04-46 var 05-04-146	1712.80	✓
64	05-04-46 var 05-04-146	1712.80	✓
65	05-04-46 var 05-04-146	1712.80	✓
66	05-04-46 var 05-04-146	1712.80	✓
67	05-04-46 var 05-04-146	1712.80	✓
68	05-04-46 var 05-04-146	1712.80	✓
69	05-04-46 var 05-04-146	1712.80	✓
70	05-04-46 var 05-04-146	1712.80	✓
71	05-04-46 var 05-04-146	1712.80	✓
72	05-04-46 var 05-04-146	1712.80	✓
73	05-04-46 var 05-04-146	1712.80	✓
74	05-04-46 var 05-04-146	1712.80	✓
75	05-04-46 var 05-04-146	1712.80	✓
76	05-04-46 var 05-04-146	1712.80	✓
77	05-04-46 var 05-04-146	1712.80	✓
78	05-04-46 var 05-04-146	1712.80	✓
79	05-04-46 var 05-04-146	1712.80	✓
80	05-04-46 var 05-04-146	1712.80	✓
81	05-04-46 var 05-04-146	1712.80	✓
82	05-04-46 var 05-04-146	1712.80	✓
83	05-04-46 var 05-04-146	1712.80	✓
84	05-04-46 var 05-04-146	1712.80	✓
85	05-04-46 var 05-04-146	1712.80	✓
86	05-04-46 var 05-04-146	1712.80	✓
87	05-04-46 var 05-04-146	1712.80	✓
88	05-04-46 var 05-04-146	1712.80	✓
89	05-04-46 var 05-04-146	1712.80	✓
90	05-04-46 var 05-04-146	1712.80	✓
91	05-04-46 var 05-04-146	1712.80	✓
92	05-04-46 var 05-04-146	1712.80	✓
93	05-04-46 var 05-04-146	1712.80	✓
94	05-04-46 var 05-04-146	1712.80	✓
95	05-04-46 var 05-04-146	1712.80	✓
96	05-04-46 var 05-04-146	1712.80	✓
97	05-04-46 var 05-04-146	1712.80	✓
98	05-04-46 var 05-04-146	1712.80	✓
99	05-04-46 var 05-04-146	1712.80	✓
100	05-04-46 var 05-04-146	1712.80	✓

22.4.83 J.E.

110 7 Lock 01-33163-1 bilz. 22.4.83 J.E.

110 7 Lock 01-33163-1 bilz. 22.4.83 J.E.

10-21915