

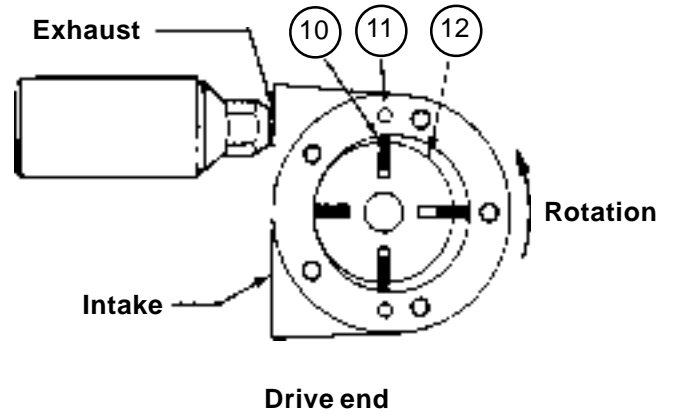

SP-A1 AIR MOTOR

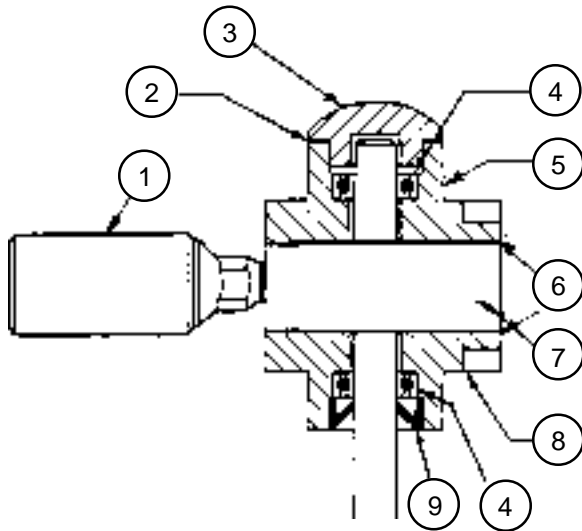

ITEM NUMBER	DESCRIPTION	PART NUMBER
1	Muffler	SAF350
2	Gasket	SAC229
3	Dead end cap	SAC228A
4	Bearing (2 req'd)	SAG549
5	Dead end plate	SAC617
6	Gasket (2 req'd)	SAC527
7	Body	SAE899
8	Drive end plate	SAC616
9	Shaft seal	SAC190A
10	Vane (4 req'd)	SAE893
11	Dowel pin (4 req'd)	SD324A
12	Rotor	SAE896
13	Repair Kit*	SK285
	Includes items numbers 2, 4, 6, 9 and 10.	
14	A1 adapter (not shown)	9007

* Items not sold separately. Item sold as part of repair kit, item 13.

**Read and understand operating and safety instructions before
operating any Standard Pump.**