

RYTON CLOSE COUPLED CHEMICAL TRANSFER PUMP

PORT SIZE 1/2"

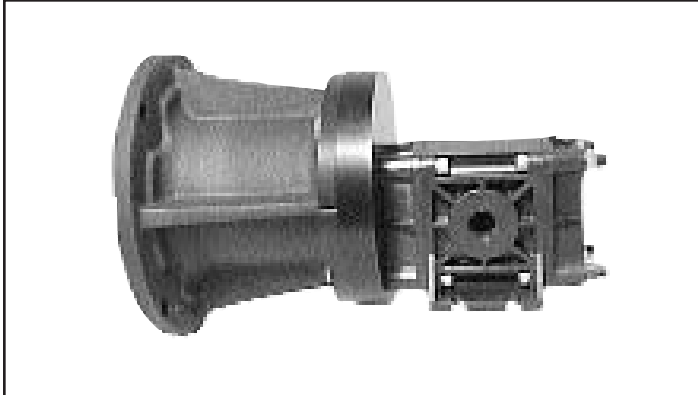

PORT SIZES 3/8" AND 3/4" ALSO AVAILABLE

FEATURES

- Designed to close couple to standard NEMA C & TC face motors with keyed shafts & feet
- Available with motor adapter and hardware. Easy field assembly to motors
- Pump is constructed of PPS plastic.
- Pump has special design ribbing and heavy wall sections for rugged service. Building block design permits ease of servicing and parts replacement.

DRIVE

The pump is driven directly from the electric motor shaft by means of a flexible coupling. An anodized aluminum adapter connects the pump to the motor.

LIQUIDS

Service life will be increased substantially if liquid pumped is clean and has lubricity value. These pumps have extremely close tolerances. Fine abrasives like sand, silt, or powders in suspension will destroy pumping ability.

SPECIFICATIONS

Max. Discharge	75 PSI
Suction Lift	18 in Hg. Max
Shaft Speed	400 to 1800 RPM
Temperature	-20 to 180 ^o F
Fluid Viscosity	30 to 50,000 SSU

Viton[®] and Teflon[®] are a registered trademarks of DuPont Dow Elastomers. Hastelloy 'C' is a registered trademark of Cabot Corp. Ryton is a registered trademark of Philips Petroleum Corp.

MARKETS

For chemical, OEM, and industrial applications where uncommon, extremely difficult, highly corrosive liquids must be pumped under pressure; where system contamination cannot be tolerated where product purity and integrity must be maintained:

- | | |
|---------------------------|------------------------|
| ■ pharmaceutical | ■ cosmetic |
| ■ chemical batching | ■ chemical formulating |
| ■ industrial plating | ■ electronic equipment |
| ■ bio-chemical equipment | ■ medical equipment |
| ■ acid etching | ■ laboratory equipment |
| ■ photo & film processing | ■ water treatment |

MATERIALS OF CONSTRUCTION

Housings	Injection molded reinforced PPS plastic. Glass fibers added for strength and stability.
Gears	Injection molded PPS plastic for close tolerances and stability. Compound additives include glass for strength and Teflon for lubricity. Plastic gears are quiet, efficient, use less power and give longer service life.
Bearings	Carbon sleeve bearings for maximum chemical compatibility also serve as thrust flanges and wear plates.
Seals	Options include packing type Grafoil rings, PTFE lip seals, or mechanical seals made of ceramic carbon, FKM, and PTFE.
Shafts	316 stainless steel or high nickel alloy 'C'.
Sealing	O-rings made from FKM or PTFE for positive sealing, independent of internal pump clearances.

Polyphenylene Sulfide PPS (Ryton[®])

An engineered, reinforced plastic, offering a wide range of chemical compatibility, physical stability, and temperature resistance (to 180^oF).

Alloy 'C'

Most used of exotic high nickel alloys. Superior corrosion resistance for commercial and reagent grades of hydrochloric and sulfuric acids and other severe alkaline and acidic pumping applications.

RYTON CLOSE COUPLED CHEMICAL TRANSFER PUMP

DIMENSIONS

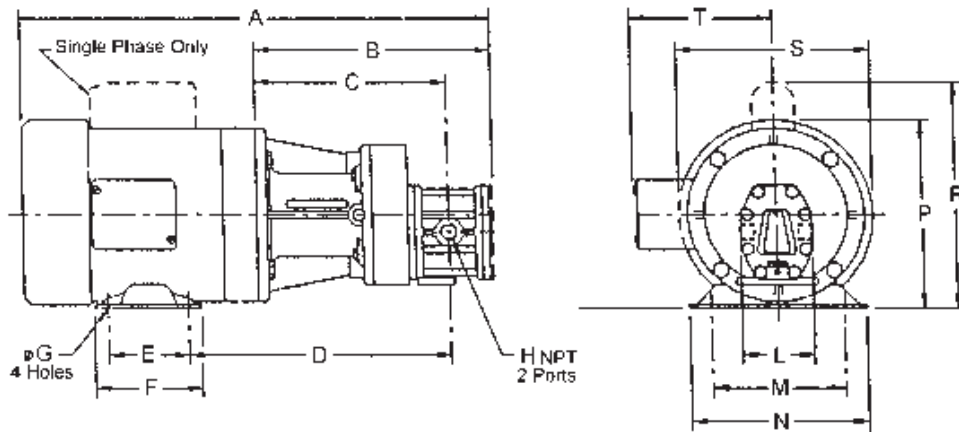

Model 214651C-S

Pump Series	Adapter Number	Motor Frame	A	B	C	D	E	F	G	H*	L	M	N	P	R	S	T
2	2AD56	56C	17.57	9.73	7.15	9.72	3.00	4.00	0.34	1/2	2.63	4.88	6.50	7.12	9.12	7.25	5.37

Overall length varies depending on HP, enclosure, speed, and motor manufacturer.

Dimensions are not to be used for construction purposes.

* These port sizes are also available: 3/8", 3/4"

Pump Model 214651C-S comes with bracket and hardware for MTG to 56C frame motor.

Repair Kit is Item # 214651CK and contains: drive/idle gear assemblies, gaskets, bearings, and seal assembly.

Viton Seal Assembly is Item # 32772.

PERFORMANCE

